

## SPADE WELD STUD

### SERIES

### JPPD INCH STEEL / PLAIN

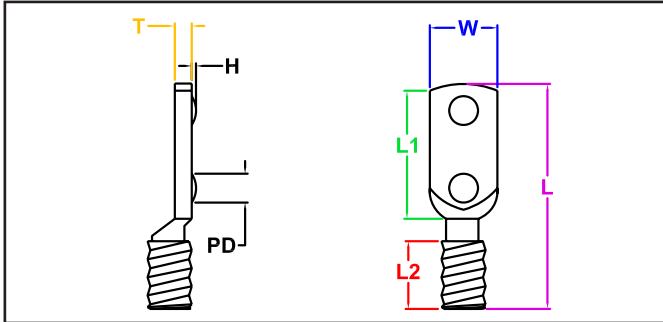

**JPPD Series - Among this weld stud's unique benefits is its ability to be welded to the edge of material. Made from a high-welding quality low carbon steel.**

Part Number	Thread Size	L Length (Overall)	L2 Minimum Thread Length	Spade			Projection	
				W Width	T Thickness $\pm 0.005$	L1 Length	PD Projection Diameter $\pm 0.005$	H Projection Height $\pm 0.003$
JPPD 1112	#6-32	0.750	0.250	0.218	0.047	0.438	0.100	0.017
JPPD 1114	#6-32	0.875	0.375	0.218	0.047	0.438	0.100	0.017
JPPD 1416	#8-32	1.000	0.375	0.250	0.062	0.500	0.110	0.020
JPPD 1420	#8-32	1.250	0.625	0.250	0.062	0.500	0.110	0.020
JPPD 1524	#10-24	1.500	0.750	0.312	0.062	0.625	0.125	0.022
JPPD 1624	#10-32	1.500	0.750	0.343	0.062	0.625	0.125	0.022
JPPD 2120	1/4-20	1.250	0.375	0.375	0.094	0.750	0.160	0.024
JPPD 2124	1/4-20	1.500	0.625	0.375	0.094	0.750	0.160	0.024
JPPD 2128	1/4-20	1.750	0.875	0.375	0.094	0.750	0.160	0.024
JPPD 2132	1/4-20	2.000	1.125	0.375	0.094	0.750	0.160	0.024
JPPD 2136	1/4-20	2.250	1.375	0.375	0.094	0.750	0.160	0.024
JPPD 2724	5/16-18	1.500	0.438	0.437	0.125	0.875	0.180	0.030
JPPD 2728	5/16-18	1.750	0.688	0.437	0.125	0.875	0.180	0.030
JPPD 3328	3/8-16	1.750	0.500	0.531	0.156	1.000	0.220	0.035
JPPD 3332	3/8-16	2.000	0.750	0.531	0.156	1.000	0.220	0.035
JPPD 3340	3/8-16	2.500	1.250	0.531	0.156	1.000	0.220	0.035
JPPD 3348	3/8-16	3.000	1.500	0.531	0.156	1.000	0.220	0.035

All Dimensions are in Millimeters

JHP Fasteners, Inc. 3721 Northridge Dr NW - Suite 40 Walker, MI 49544	Drawing No	P - 800.783.0910 P - 616.784.7900 F - 616.913.0085
	Scale NTS	Drawing No <b>JPPD</b>

## SPADE WELD STUD

### SERIES

JPPDZ  
INCH

STAINLESS STEEL/PLAIN

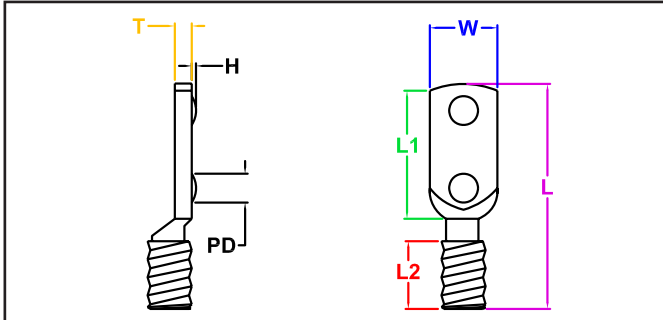

**JPPD Series - Among this weld stud's unique benefits is its ability to be welded to the edge of material. Made from 18-8 stainless steel.**

Part Number	Thread Size	L Length (Overall)	L2 Minimum Thread Length	Spade			Projection	
				W Width	T Thickness $\pm 0.005$	L1 Length	PD Diameter $\pm 0.005$	H Height $\pm 0.003$
PDZ 1114	#6-32	0.875	0.375	0.218	0.047	0.438	0.100	0.017
PDZ 1416	#8-32	1.000	0.375	0.250	0.062	0.500	0.110	0.020
PDZ 1420	#8-32	1.250	0.625	0.250	0.062	0.500	0.110	0.020
PDZ 1524	#10-24	1.500	0.750	0.312	0.062	0.625	0.125	0.022
PDZ 1624	#10-32	1.500	0.750	0.343	0.062	0.625	0.125	0.022
PDZ 2120	1/4-20	1.250	0.375	0.375	0.094	0.750	0.160	0.024
PDZ 2124	1/4-20	1.500	0.625	0.375	0.094	0.750	0.160	0.024
PDZ 2128	1/4-20	1.750	0.875	0.375	0.094	0.750	0.160	0.024
PDZ 2132	1/4-20	2.000	1.125	0.375	0.094	0.750	0.160	0.024
PDZ 2136	1/4-20	2.250	1.375	0.375	0.094	0.750	0.160	0.024
PDZ 2724	5/16-18	1.500	0.438	0.437	1.250	0.875	0.180	0.030
PDZ 2728	5/16-18	1.750	0.688	0.437	1.250	0.875	0.180	0.030

All Dimensions are in Millimeters

JHP Fasteners, Inc. 3721 Northridge Dr NW - Suite 40 Walker, MI 49544	Drawing No	P - 800.783.0910 P - 616.784.7900 F - 616.913.0085
	Scale NTS	JPPDZ Revision Drawn by: M McCormick